

Soldered fittings

Piping technology
copper/gunmetal



Fittings made of gunmetal in acc. with DVGW worksheet GW 6 and fittings made of copper in acc. with DVGW worksheet GW 8 for copper pipes in acc. with DVGW worksheet GW 392.

Certificates

- BHKS and ZVSHK liability transfer agreements for copper and gunmetal fittings as well as wall lead-ins made of gunmetal
- Fittings made of copper in acc. with DVGW-AB GW 8, DVGW-Reg.-No. DV-7411AO2955, quality seal RAL-RG 641/4
- Fittings made of gunmetal in acc. with DVGW-AB GW 6, DVGW-Reg.-No. DV-7401AO2956

Note

Elbow model 95090 and model 95092 do not conform to DVGW worksheet GW 8 and are not approved for use in gas and drinking water installations!

Marking

DVGW test mark
Quality seal RAL-RG 641/4



= Quality seal for d 12-54

Official quality seal



INDEX

Elbows	4
Elbows	6
T-pieces	6
Cross T-pieces	9
Adapter pieces/adapter elbows	10
Couplings	12
Reductions	13
Screw fittings	14
Caps, plugs	17
Wall plates	18
Mounting units	19
Wall lead-ins	22



GTIN-Code (Global Trade Item Number, previously EAN-Code)

The GTIN-Code composed out of the constant manufacturer number 4015211 and a six-digit article code - in this example 305 611. The exchange of the last six digits against the article code shows the GTIN-Code.

ELBOWS

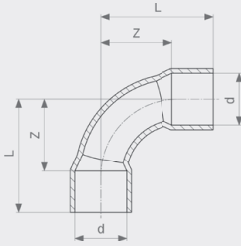

Elbow 90°
- copper
Model 95002A

article	Cu	d	Z	L
122 645		6	8	14
109 288		8	10	17
102 494		10	14	22
100 513	✓	12	14	23
467 463	✓	14	17	28
100 018	✓	15	18	29
467 470	✓	16	19	30
100 148	✓	18	19	32
100 063	✓	22	26	42
100 193	✓	28	32	52
101 046	✓	35	42	65
102 777	✓	42	50	77
104 115	✓	54	65	97
119 829		64.0	83	116
125 080		76.1	100	134
127 077		88.9	112	150
138 431		108.0	177	225

Cu = quality seal for d12-54

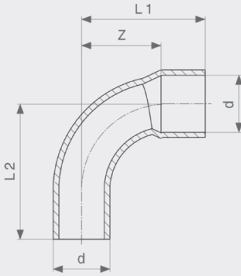

Elbow 90°
- copper
Model 95001A

article	Cu	d	Z	L1	L2
117 184		8	10	17	18
105 136		10	14	22	24
101 510	✓	12	14	23	25
465 742	✓	14	17	28	28
100 155	✓	15	18	29	31
467 456	✓	16	19	30	30
100 575	✓	18	22	35	37
100 391	✓	22	26	42	43
100 827	✓	28	34	53	55
103 415	✓	35	42	65	67
108 052	✓	42	50	77	79
112 028	✓	54	65	97	98
594 350		64.0	76	108	110
634 254		76.1	92	125	128
634 261		88.9	107	144	148

Cu = quality seal for d12-54

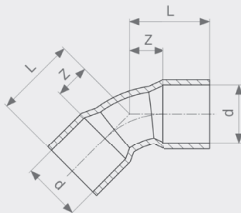

Elbow 45°
- copper
Model 95041

article	Cu	d	Z	L
110 420		10	6	14
103 309	✓	12	5	14
467 500	✓	14	6	17
100 483	✓	15	6	17
467 517	✓	16	7	18
101 077	✓	18	8	20
100 704	✓	22	9	25
101 459	✓	28	12	31
104 016	✓	35	14	38
108 823	✓	42	17	44
112 196	✓	54	22	54
138 394		64.0	37	70
144 043		76.1	33	67
144 425		88.9	40	78
158 071		108.0	62	110

Cu = quality seal for d12-54

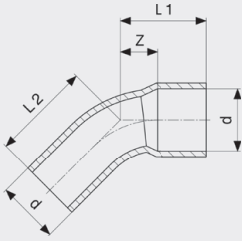

Elbow 45°
- copper
Model 95040

article	Cu	d	Z	L1	L2
109 325		10	6	14	16
103 019	✓	12	5	15	16
467 487	✓	14	6	17	17
100 292	✓	15	6	17	19
467 494	✓	16	7	18	18
100 773	✓	18	8	20	22
100 605	✓	22	9	25	27
101 336	✓	28	12	31	33
104 955	✓	35	14	38	40
110 338	✓	42	17	44	46
114 916	✓	54	22	54	56
594 244		64.0	32	64	66
633 837		76.1	38	71	74
633 844		88.9	44	82	85

Cu = quality seal for d12-54

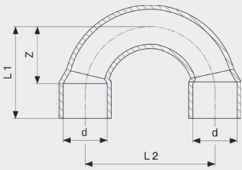

Elbow 180°
- copper
Model 95060

article	d	Z	L1	L2
117 542	10	16	24	30
121 785	12	17	26	34
115 951	15	22	34	45
113 445	18	26	39	52
121 518	22	32	48	66
128 029	28	41	60	84

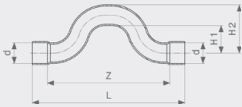

Crossover
- copper
Model 95085

article	Cu	d	Z	L	H1	H2
102 159	✓	15	90	112	20	35
104 672	✓	18	102	128	20	38
103 798	✓	22	115	147	23	45

Cu = quality seal for d12-54

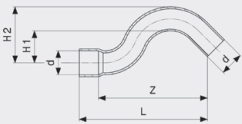

Crossover
- copper
Model 95086

article	Cu	d	Z	L	H1	H2
107 864	✓	12	66	76	20	32
102 012	✓	15	68	80	20	35
104 481	✓	18	73	87	20	38
105 396	✓	22	86	104	23	45

Cu = quality seal for d12-54

ELBOWS

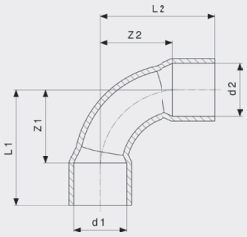

Elbow 90°
- copper
Model 95090

article	d1	d2	Z1	Z2	L1	L2
107 901	8	8	7	7	14	14
103 132	10	10	14	14	22	22
100 803	12	12	12	12	21	21
467 524	14	14	14	14	25	25
116 897	15	12	15	21	26	30
100 094	15	15	10	10	21	21
467 531	16	16	16	16	27	27
100 452	18	18	16	16	29	29
100 278	22	22	15	15	31	31
100 711	28	28	19	19	38	38
103 088	35	35	28	28	51	51
106 416	42	42	34	34	61	61
109 905	54	54	45	45	77	77
594 411	64.0	64.0	76	76	108	108
594 428	76.1	76.1	66	66	100	100
594 435	88.9	88.9	78	78	116	116
594 442	108.0	108.0	130	130	178	178

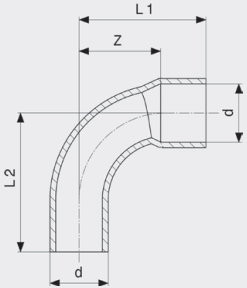

Elbow 90°
- copper
Model 95092

article	d	Z	L1	L2
113 773	8	11	18	18
108 700	10	14	22	24
102 920	12	12	21	25
467 548	14	14	25	25
100 414	15	12	23	25
467 555	16	16	27	27
101 169	18	16	28	30
100 933	22	18	34	37
102 067	28	25	44	46
107 079	35	28	51	55
113 995	42	34	61	65
118 891	54	45	77	81

T-PIECES

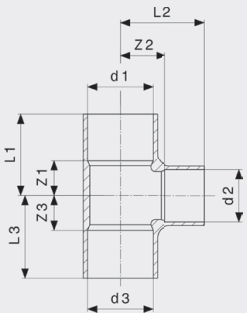

T-piece
- copper
Model 95130

article	Cu	d1	d2	d3	Z1	Z2	Z3	L1	L2	L3
107 475		6	6	6	5	4	5	11	10	11
128 968		8	6	8	6	7	6	13	13	13
105 747		8	8	8	6	5	6	13	12	13
120 009		10	6	10	4	6	4	13	13	13
104 092		10	10	10	6	6	6	14	14	14
136 635		12	8	12	7	9	7	16	16	16
109 745		12	10	12	7	8	7	16	16	16
101 435	✓	12	12	12	7	7	7	16	16	16
106 799*	✓	12	15	12	11	8	11	20	19	20

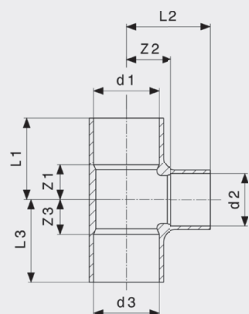

T-piece
- copper
Model 95130

article	Cu	d1	d2	d3	Z1	Z2	Z3	L1	L2	L3
584 412	✓	14	12	12	8	8	14	19	17	23
467 586	✓	14	12	14	8	8	8	18	17	18
584 429	✓	14	14	12	8	8	15	19	19	24
467 562	✓	14	14	14	8	8	8	18	19	18
584 436	✓	14	16	14	8	9	8	20	20	20
120 245		15	8	15	8	12	8	19	18	19
106 355		15	10	15	8	10	8	19	18	19
103 569	✓	15	12	12	8	10	14	19	20	23
101 848	✓	15	12	15	8	10	8	19	20	19
104 863	✓	15	15	12	8	9	15	19	20	24
100 131	✓	15	15	15	8	9	8	19	20	19
103 200	✓	15	18	15	13	10	13	24	23	24
105 143	✓	15	22	15	16	13	16	27	29	27
584 443	✓	16	12	14	8	9	14	19	18	25
467 593	✓	16	12	16	8	9	8	19	18	19
584 962	✓	16	14	12	8	9	16	19	20	25
584 955	✓	16	14	14	8	9	13	19	20	24
467 609	✓	16	14	16	8	9	8	18	20	18
467 579	✓	16	16	16	8	9	8	20	20	20
584 979	✓	16	18	14	13	11	16	24	24	27
584 986	✓	16	18	16	13	11	13	24	24	24
120 122	✓	18	12	12	8	13	8	21	22	25
107 413	✓	18	12	15	8	13	14	21	22	25
103 606	✓	18	12	18	8	13	8	21	22	21
584 993	✓	18	14	14	8	10	14	21	21	25
585 006	✓	18	14	16	8	10	14	21	21	25
467 616	✓	18	14	18	8	10	8	20	21	20
101 053	✓	18	15	15	8	13	14	21	24	25
100 582	✓	18	15	18	8	13	8	21	24	21
585 013	✓	18	16	14	8	10	14	21	21	25
585 020	✓	18	16	16	8	10	14	21	21	25
467 623	✓	18	16	18	8	10	8	22	21	22
114 565	✓	18	18	12	10	10	18	23	23	27
585 037	✓	18	18	14	10	10	16	23	23	27
102 890	✓	18	18	15	10	10	16	23	23	27
585 044	✓	18	18	16	10	10	16	23	23	27
100 612	✓	18	18	18	10	11	10	23	24	23
104 689	✓	18	22	18	14	13	14	28	29	28
104 733	✓	22	12	22	8	15	8	24	24	24
592 585	✓	22	14	18						
467 630	✓	22	14	22	8	12	8	24	23	24
101 725	✓	22	15	15	8	12	17	24	23	28
102 944	✓	22	15	18	8	12	7	24	23	28
100 445	✓	22	15	22	8	12	8	24	23	24
585 051	✓	22	16	16	8	12	18	24	23	28
585 068	✓	22	16	18	8	12	16	24	23	28
467 647	✓	22	16	22	10	12	10	26	23	26
105 297	✓	22	18	15	11	14	11	27	27	32
585 075	✓	22	18	16	11	14	21	27	27	32
103 217	✓	22	18	18	11	14	19	27	27	32
101 497	✓	22	18	22	11	14	11	27	27	27
585 082	✓	22	22	14	12	12	22	28	28	33
102 456	✓	22	22	15	12	12	22	28	28	33
585 099	✓	22	22	16	12	12	22	28	28	33
104 702	✓	22	22	18	12	12	20	28	28	33
100 476	✓	22	22	22	12	12	12	28	28	28
105 204	✓	22	28	22	20	14	20	36	34	36
114 183	✓	28	12	28	10	20	10	29	28	29

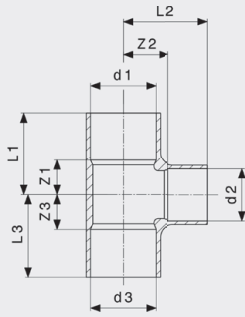

T-piece
- copper
Model 95130

article	Cu	d1	d2	d3	Z1	Z2	Z3	L1	L2	L3
106 737	✓	28	15	22	11	18	20	30	28	36
101 619	✓	28	15	28	10	18	10	29	28	29
114 947	✓	28	18	18	12	18	24	31	30	37
109 219	✓	28	18	22	12	18	21	31	30	37
102 852	✓	28	18	28	10	18	10	29	30	29
112 943	✓	28	22	15	12	18	26	31	34	37
122 119	✓	28	22	18	12	18	24	31	34	37
103 248	✓	28	22	22	12	18	21	31	34	37
101 282	✓	28	22	28	12	18	12	31	34	31
109 424	✓	28	28	15	15	16	29	34	34	40
113 032	✓	28	28	18	15	16	27	34	36	40
106 232	✓	28	28	22	15	16	24	34	34	40
101 022	✓	28	28	28	15	16	15	34	34	34
115 760	✓	28	35	28	20	18	20	39	41	39
107 291	✓	35	15	35	10	24	10	33	35	33
109 899	✓	35	18	35	11	23	11	34	36	34
123 673	✓	35	22	22	14	21	28	38	37	44
113 599	✓	35	22	28	14	21	26	38	37	44
104 375	✓	35	22	35	12	21	12	36	37	36
122 676	✓	35	28	22	23	19	16	41	42	49
110 727	✓	35	28	28	18	22	28	41	42	46
105 808	✓	35	28	35	16	22	16	39	42	39
121 235	✓	35	35	22	21	22	35	44	45	51
117 580	✓	35	35	28	21	22	32	44	45	51
104 184	✓	35	35	35	19	22	19	42	44	42
118 556	✓	42	15	42	13	28	13	40	39	40
125 479	✓	42	18	42	14	26	14	42	39	42
111 595	✓	42	22	42	16	26	16	43	42	43
110 383	✓	42	28	42	18	26	18	45	45	45
122 591	✓	42	35	35	23	26	34	50	49	57
113 711	✓	42	35	42	23	26	23	50	49	50
108 236	✓	42	42	42	26	25	26	52	52	52
118 792	✓	54	22	54	18	33	18	50	49	50
117 467	✓	54	28	54	18	34	18	50	53	50
117 818	✓	54	35	54	25	33	25	57	56	57
119 652	✓	54	42	54	26	34	26	58	61	58
110 819	✓	54	54	54	32	33	32	64	65	64
595 227		64.0	42	64.0	28	42	28	55	64	55
595 234		64.0	54	64.0	31	37	31	64	69	64
131 722		64.0	64.0	64.0	36	36	36	68	68	68
595 357		76.1	54	76.1	29	42	29	63	74	63
595 364		76.1	64.0	76.1	28	55	28	67	76	67
135 911		76.1	76.1	76.1	41	46	41	75	80	75
634 292		88.9	54	88.9	33	47	33	71	79	71
595 241		88.9	64.0	88.9	38	48	38	76	81	76
595 371		88.9	76.1	88.9	44	44	44	81	83	81
137 021		88.9	88.9	88.9	60	60	60	99	99	99
151 003		108.0	108.0	108.0	60	60	60	107	107	107

Cu = quality seal for d12-54

* = Discontinued, limited availability

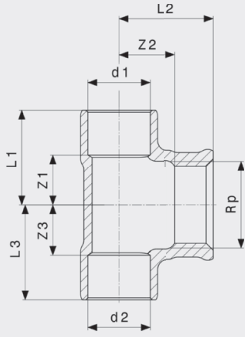

T-piece
- gunmetal
Model 94130G

article	d1	Rp	d2	Z1	Z2	Z3	L1	L2	L3
150 600	12	1/2	12	13	7	13	22	22	22
475 772	14	1/2	14	12	8	12	23	23	23
131 029	15	3/8	15	10	6	10	21	18	21
102 401	15	1/2	15	12	8	12	23	23	23
475 789	16	1/2	16	12	10	12	23	24	23
140 823	18	3/8	18	10	7	10	23	18	23
103 767	18	1/2	18	12	8	12	24	23	24
157 999	18	3/4	18	17	9	17	30	25	30
119 195	22	3/8	22	11	9	11	26	20	26
101 978	22	1/2	22	11	10	11	26	25	26
109 141	22	3/4	22	17	10	17	32	26	32
103 453	28	1/2	28	14	14	14	32	28	32
112 035	28	3/4	28	15	15	15	34	31	34
258 955	28	1	28	20	13	20	39	32	39
152 734	35	1/2	35	13	12	13	36	27	36
123 390	35	3/4	35	15	12	15	38	28	38
136 734	35	1 1/4	35	26	24	26	49	45	49
157 678	42	1 1/2	42	26	16	26	53	37	53

CROSS T-PIECES

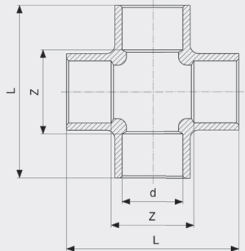

Cross piece
- gunmetal
Model 94180

article	d	Z	L
138 851	15	20	42
134 464	18	24	50
121 884	22	27	58
135 508	28	34	71

ADAPTER PIECES/ADAPTER ELBOWS

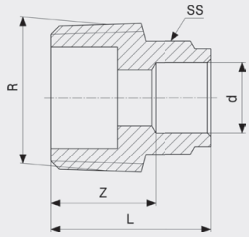

Adapter
- gunmetal
Model 94243G

article	d	R	Z	L	SS
151 614	8	¼	12	19	17
145 002	8	¾	12	20	12
136 673	10	¼	11	20	14
114 060	10	¾	11	19	12
112 400	10	½	15	23	14
132 620	12	¼	12	21	16
101 152	12	¾	12	21	16
101 398	12	½	14	22	16
467 746	14	¾	14	25	18
467 739	14	½	14	25	18
101 657	15	¾	13	24	19
100 025	15	½	15	26	18
102 234	15	¾	16	27	19
467 753	16	½	14	26	20
467 760	16	¾	15	26	20
100 650	18	½	15	28	21
101 039	18	¾	13	26	21
101 749	22	½	17	33	26
100 322	22	¾	16	32	26
100 889	22	1	16	32	26
121 228	28	½	18	37	32
102 913	28	¾	18	37	32
100 285	28	1	18	37	32
105 839	28	1¼	19	40	32
107 109	35	1	22	45	39
102 661	35	1¼	21	44	42
174 484	35	1½	12	35	42
141 905	42	1¼	26	53	48
106 638	42	1½	21	48	48
258 481	42	2	15	42	48
169 305	54	1½	28	60	61
109 196	54	2	30	62	61
138 202	64.0	2½	24	57	71
137 236	76.1	2½	34	68	83
140 007	88.9	3	41	79	97
159 634	108.0	4	48	96	119

SS = spanner size

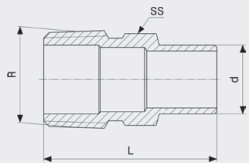

Adapter
- gunmetal
Model 94280G

article	d	R	L	SS
116 040	15	½	38	18
120 221	18	½	40	20
131 166	22	½	44	24
117 894	22	¾	44	25
126 940	28	1	51	30
140 946	35	1¼	60	40
142 841	42	1½	61	48

SS = spanner size

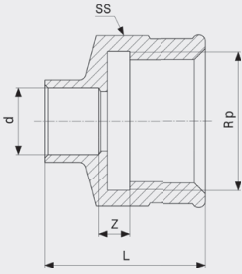

Adapter
- gunmetal
Model 94270G

article	d	Rp	Z	L	SS
118 976	10	¼	1	20	16
118 051	10	¾	1	21	20
119 515	10	½	1	24	25
105 259	12	¾	2	22	20
104 214	12	½	1	25	25
475 758	14	½	2	28	25
101 787	15	¾	2	24	20
100 254	15	½	2	28	25
104 771	15	¾	2	29	30
475 765	16	½	2	28	25
100 940	18	½	2	30	25
102 180	18	¾	2	31	30
101 664	22	½	2	33	25
100 728	22	¾	1	34	30
102 470	22	1	1	36	38
104 139	28	¾	2	37	30
100 964	28	1	2	40	38
107 192	28	1¼	4	44	47
165 864	35	¾	0	40	34
107 857	35	1	1	43	40
108 267	35	1¼	6	50	48
163 419	42	1¼	6	54	49
117 597	42	1½	4	52	53
160 586	54	2	3	61	66
144 418	64.0	2½	4	66	83

SS = spanner size

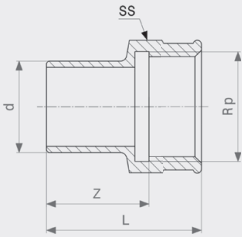

Plug-in piece
- gunmetal
Model 94246G

article	d	Rp	Z	L	SS
117 917	12	¾	14	26	20
119 669	12	½	17	32	26
467 784*	14	½	15	30	25
118 549	15	¾	16	27	20
106 553	15	½	16	32	25
111 274	18	½	18	33	25
132 873	18	¾	20	36	31
112 455	22	½	21	36	25
118 846	22	¾	21	38	30
131 838	28	¾	24	40	30
117 849	28	1	25	44	38
133 252	35	1¼	37	58	49

SS = spanner size

* = Discontinued, limited availability

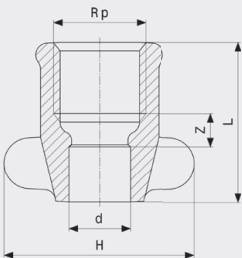

Adapter
- gunmetal
Model 94270GF

article	d	Rp	Z	L	H
103 880	15	½	6	32	40

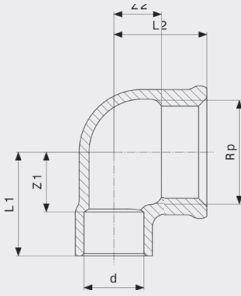

Adapter elbow 90°
- gunmetal
Model 94090G

article	d	Rp	Z1	Z2	L1	L2
117 887	12	3/8	11	5	20	16
105 693	12	1/2	12	4	21	19
467 692	14	1/2	13	12	24	22
148 362	15	3/8	10	6	21	18
100 667	15	1/2	12	6	22	22
130 114	15	3/4	17	7	28	23
467 708	16	1/2	13	12	24	22
104 436	18	1/2	12	8	24	23
109 011	18	3/4	16	8	28	24
106 102	22	1/2	11	8	27	23
107 581	22	3/4	16	10	32	26
113 865	22	1	19	11	35	30
144 203	28	3/4	15	14	34	30
109 561	28	1	21	13	40	32
173 494	35	1 1/4	23	19	46	40
166 397	42	1 1/2	26	24	53	45
151 676	54	2	32	29	64	55

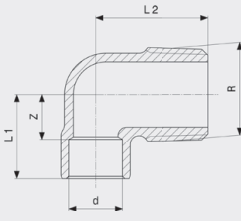

Adapter elbow 90°
- gunmetal
Model 94092G

article	d	R	Z	L1	L2
103 910	12	3/8	9	18	22
108 687	12	1/2	10	19	26
467 715	14	1/2	12	23	29
106 577	15	3/8	10	21	26
100 568	15	1/2	10	20	28
467 722	16	1/2	12	23	29
107 635	18	1/2	18	32	30
133 108	18	3/4	14	26	31
136 307	22	1/2	11	27	33
107 208	22	3/4	14	29	33
144 067	22	1	17	32	39
131 739	28	3/4	18	33	38
149 970	28	1	19	38	46
138 691	35	1 1/4	22	45	44

COUPLINGS

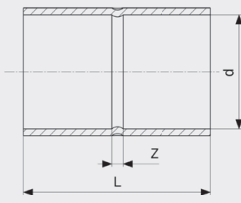

Coupling
- copper
Model 95270

article	Cu	d	Z	L
108 717		6	1	13
107 093		8	1	15
102 357		10	1	17
100 872	✓	12	2	19
467 654	✓	14	2	23
100 117	✓	15	2	23
467 661	✓	16	2	23
100 469	✓	18	2	27
100 353	✓	22	2	32
100 698	✓	28	2	38
102 616	✓	35	2	48
105 433	✓	42	2	56
106 744	✓	54	2	66
124 038		64.0	5	70
127 862		76.1	4	72
128 319		88.9	5	80
146 481		108.0	4	100

Cu = quality seal for d12-54

REDUCTIONS

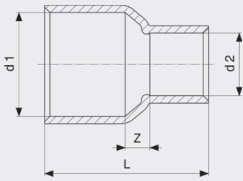

Reducing coupling
- copper
Model 95240

article	Cu	d1	d2	Z	L
142 872		8	6	4	17
121 082		10	6	2	16
121 150		10	8	2	18
120 504		12	8	5	24
107 420		12	10	4	20
585 136		14	10	4	23
464 301	✓	14	12	4	23
110 154		15	10	5	23
102 524	✓	15	12	5	26
464 318	✓	16	12	6	25
464 325	✓	16	14	4	25
106 874	✓	18	12	6	29
464 332	✓	18	14	6	29
101 176	✓	18	15	4	27
464 349	✓	18	16	4	27
110 758	✓	22	12	9	36
464 356	✓	22	14	8	34
101 565	✓	22	15	7	37
464 363	✓	22	16	7	33
101 602	✓	22	18	6	34
105 037	✓	28	15	12	44
585 143	✓	28	16	8	38
106 256	✓	28	18	7	42
102 111	✓	28	22	5	43
109 738	✓	35	22	11	50
105 334	✓	35	28	9	52
121 280	✓	42	22	23	66
117 269	✓	42	28	12	59
111 687	✓	42	35	10	60
124 076	✓	54	28	24	77
120 788	✓	54	35	14	69
116 118	✓	54	42	11	70
594 374		64.0	54	12	77
634 278		76.1	54	24	90
594 381		76.1	64.0	14	80
594 398		88.9	76.1	15	86
594 404		108.0	88.9	20	105

Cu = quality seal for d12-54

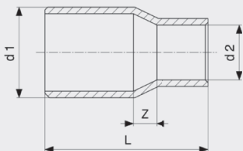

Reducer
- copper
Model 95243

article	Cu	d1	d2	Z	L
124 540		10a	6	2	18
119 805		10a	8	1	19
123 796		12a	6	3	24
116 187		12a	8	3	23
104 290		12a	10	1	19
465 674	✓	14a	12	2	22
105 983		15a	10	6	26
101 060	✓	15a	12	3	24
465 681	✓	16a	12	2	22
465 698	✓	16a	14	3	25
104 566	✓	18a	12	4	27
465 704	✓	18a	14	3	27
100 520	✓	18a	15	4	29
465 711	✓	18a	16	3	27
108 298	✓	22a	12	7	33
465 728	✓	22a	14	6	33
100 841	✓	22a	15	6	37
465 735	✓	22a	16	6	33
100 780	✓	22a	18	5	35
118 013	✓	28a	12	10	39
585 112	✓	28a	14	9	39
103 156	✓	28a	15	8	39

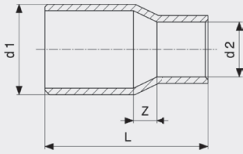

Reducer
- copper
Model 95243

article	Cu	d1	d2	Z	L
585 129	✓	28a	16	9	39
103 637	✓	28a	18	6	39
101 015	✓	28a	22	6	42
115 296	✓	35a	15	18	54
115 180	✓	35a	18	16	54
105 792	✓	35a	22	10	53
103 118	✓	35a	28	8	52
133 313	✓	42a	15	22	62
116 392	✓	42a	22	14	60
110 260	✓	42a	28	9	56
106 935	✓	42a	35	5	57
118 648	✓	54a	28	25	78
115 852	✓	54a	35	14	73
112 530	✓	54a	42	8	69
594 169		64.0a	35	21	78
594 176		64.0a	42	17	79
126 261		64.0a	54	6	75
594 190		76.1a	35	26	86
594 183		76.1a	42	23	86
127 732		76.1a	54	12	82
594 206		76.1a	64.0	10	79
634 308		88.9a	54	22	96
594 237		88.9a	64.0	18	92
132 866		88.9a	76.1	12	87
594 213		108.0a	64.0	27	111
594 220		108.0a	76.1	22	107
150 709		108.0a	88.9	15	103

Cu = quality seal for d12-54

SCREW FITTINGS

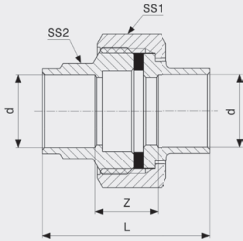

Screw fitting
- gunmetal
Model 94330

article	d	Z	L	SS1	SS2
110 239	15	13	35	29	19
122 249	18	14	40	29	22
116 583	22	14	45	36	26
154 196	28	18	55	46	32
176 174	35	22	68	52	40

SS = spanner size

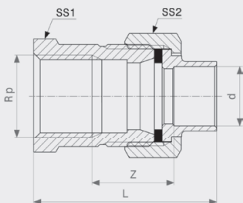

Adapter union
- gunmetal/brass
Model 94330G

article	d	Rp	Z	L	SS1	SS2
113 421	15	1/2	21	47	29	27
120 856	18	1/2	22	50	29	27
117 399	22	3/4	22	54	36	34
119 478	28	1	21	59	46	44

SS = spanner size

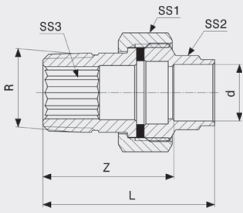

Adapter union
- gunmetal/brass
Model 94331G

article	d	R	Z	L	SS1	SS2	SS3
109 806	15	1/2	35	46	29	19	12
120 146	18	1/2	35	48	29	22	12
112 967	22	3/4	38	54	36	26	17
133 535	28	1	44	63	46	32	22
220 839	35	1 1/4	51	74	52	35	

SS = spanner size

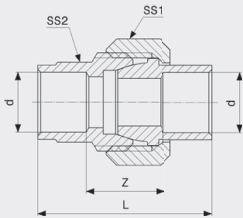

Screw fitting
- gunmetal
Model 94340

article	d	Z	L	SS1	SS2
132 033	10	13	30	18	12
151 645	12	12	30	23	16
103 699	15	13	35	29	19
124 434	18	14	40	29	22
104 399	22	13	45	36	26
107 604	28	16	54	46	32
114 695	35	20	66	52	40
125 899	42	21	76	58	49
148 256	54	27	91	74	61

SS = spanner size

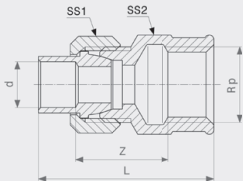

Adapter union
Model 94340G

article	d	Rp	Z	L	SS1	SS2
163 051	12	1/2	17	41	23	25
122 683	15	3/8	15	38	29	22
103 422	15	1/2	21	47	29	27
110 390	15	3/4	20	47	29	30
106 690	18	1/2	21	49	29	27
109 295	18	3/4	20	49	29	30
101 527	22	3/4	21	53	36	34
105 310	22	1	23	58	36	40
103 002	28	1	20	58	46	44
107 918	35	1 1/4	25	70	52	50
115 937	42	1 1/2	23	72	58	55
125 325	54	2	22	81	74	66

SS = spanner size

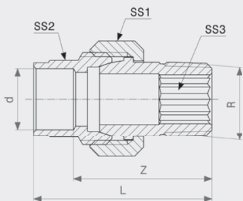

Adapter union
Model 94341G

article	d	R	Z	L	SS1	SS2	SS3
118 921	12	3/8	29	38	23	16	8
147 099	12	1/2	36	45	29	16	12
115 883	15	3/8	31	42	23	18	8
102 128	15	1/2	33	44	29	19	12
122 959	15	3/4	39	50	36	18	17
109 042	18	1/2	34	47	29	22	12
109 547	18	3/4	38	51	36	22	17
101 558	22	3/4	36	52	36	26	17
109 080	22	1	44	59	46	26	22
103 705	28	1	41	60	46	32	22
108 427	35	1 1/4	45	68	52	40	
118 327	42	1 1/2	50	78	58	49	
129 620	54	2	54	86	74	61	

SS = spanner size

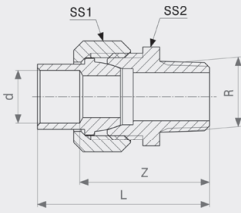

Adapter union
- gunmetal
Model 94343G

article	d	R	Z	L	SS1	SS2
167 202	12	3/8	29	38	23	22
134 716	12	1/2	33	42	22	23
102 395	15	1/2	35	46	29	27
120 771	15	3/4	39	50	29	28
111 984	18	1/2	35	48	29	27
116 859	18	3/4	39	52	29	28
102 685	22	3/4	40	55	36	34
115 098	22	1	41	57	36	34
103 996	28	1	44	63	46	44
110 581	35	1 1/4	52	75	52	50
115 135	42	1 1/2	54	82	58	55
119 980	54	2	65	97	74	71
144 005	64.0	2 1/2	78	110	93	90
165 918	76.1	2 1/2	76	110	102	98

SS = spanner size

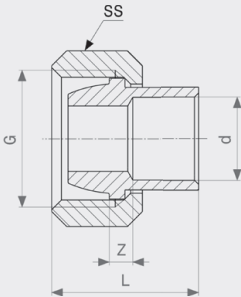

Connection screw fitting
- gunmetal
Model 94384G

article	d	G	Z	L	SS
136 666	12	1/2	2	19	23
113 148	15	3/4	2	23	29
130 367	18	3/4	2	25	29
116 323	22	1	2	28	36
125 998	28	1 1/4	2	32	46
130 794	35	1 1/2	5	40	52
138 745	42	1 3/4	4	44	58
140 366	54	2 3/8	6	51	74

SS = spanner size

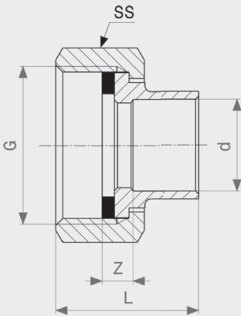

Connection screw fitting
Model 94359

article	d	G	Z	L	SS
288 402	15	3/4	5	24	29
288 396	18	3/4	6	27	29
288 389	22	1	5	29	36
288 372	28	1 1/4	6	34	46
288 365	35	1 1/2	10	42	52
288 358	42	1 3/4	7	44	58
288 341	54	2 3/8	9	50	74

SS = spanner size

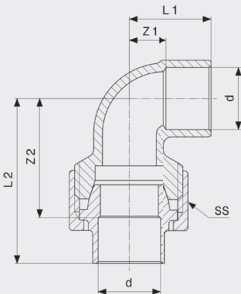

Adapter union
- gunmetal
Model 94096

article	d	Z1	Z2	L1	L2	SS
123 499	15	9	30	20	41	29
134 815	18	12	32	25	44	29
133 276	22	14	36	30	52	36
146 368	28	18	42	37	60	46

SS = spanner size

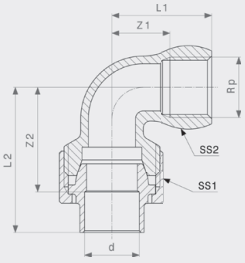

**Adapter union
Model 94096G**

article	d	Rp	Z1	Z2	L1	L2	SS1	SS2
114 787	15	1/2	18	31	33	42	29	28
119 461	18	1/2	21	31	33	44	29	28
216 962	18	3/4	23	39	39	52	36	33
107 338	22	3/4	23	37	39	53	36	33
120 498	22	1	25	40	44	56	36	40
112 295	28	1	28	44	47	63	46	39
121 433	35	1 1/4	35	50	56	73	52	48

SS = spanner size

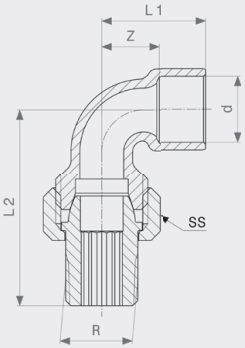

**Adapter union
Model 94098G**

article	d	R	Z	L1	L2	SS
120 979	12	1/2	9	18	49	29
103 859	15	1/2	9	20	49	29
110 017	18	1/2	12	25	51	29
120 580	18	3/4	12	25	59	36
114 909	22	3/4	14	30	59	36
144 128	28	1	18	37	68	46
120 061	35	1 1/4	22	45	76	52
144 098	42	1 1/2	24	51	85	59
146 450	54	2	28	60	100	74

SS = spanner size

CAPS, PLUGS

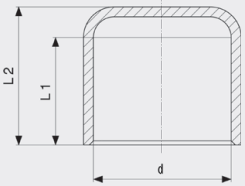

**Cap
- copper
Model 95301**

article	d	L1	L2
121 273	8	7	9
108 892	10	8	10
104 450	12	9	11
467 678	14	11	13
101 466	15	11	13
467 685	16	11	13
103 590	18	13	15
102 951	22	15	18
105 662	28	18	21
109 134	35	24	29
113 155	42	27	33
114 077	54	32	37
594 367	64.0	32	37

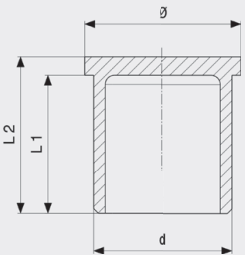

**Plug
- copper
Model 95290**

article	d	L1	L2	Ø
118 945*	15	15	17	17

Ø = diameter

* = Discontinued, limited availability

WALL PLATES

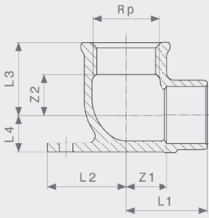

Wall plate
- gunmetal
Model 94471G

article	d	Rp	Z1	Z2	L1	L2	L3	L4
103 958	12	1/2	13	5	22	25	20	9
101 275	15	1/2	13	6	24	25	22	10
106 393	18	1/2	13	8	26	25	23	12
113 216	18	3/4	16	8	29	30	24	12
110 192	22	1/2	15	8	30	21	23	15
111 304	22	3/4	17	10	32	21	26	15
151 812	28	1	19	15	37	34	34	18

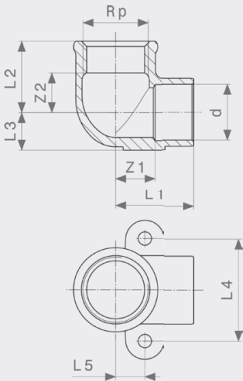

Wall plate
- gunmetal
Model 94472G

article	d	Rp	Z1	Z2	L1	L2	L3	L4	L5
103 965	12	1/2	13	5	22	20	9	33	9
467 791	14	1/2							
112 813	15	3/8	10	6	21	18	11	34	
100 223	15	1/2	12	6	22	22	10	33	9
467 807	16	1/2							
102 210	18	1/2	13	8	26	23	12	33	9
113 490	22	3/4	17	10	32	26	14	42	12

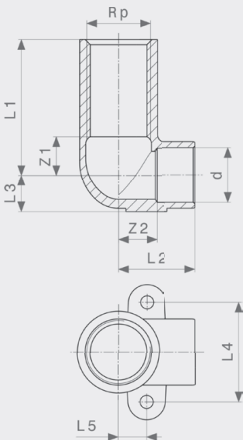

Wall plate
- gunmetal
Model 94472GL

article	d	Rp	L	Z1	Z2	L1	L2	L3	L4	L5
105 129	15	1/2	45	12	13	45	24	10	33	10

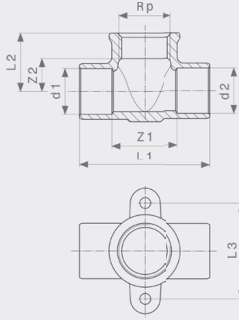

Wall plate T-piece
- gunmetal
Model 94490G

article	d1	Rp	d2	Z1	Z2	L1	L2	L3
118 310	15	1/2	15	30	7	52	22	38
138 127	18	1/2	18	26	8	52	23	38
122 287	22	1/2	22	23	14	56	28	48

MOUNTING UNITS

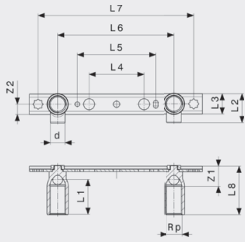

Gemini Mounting unit
Model 94476

article	d	Rp	L	DG	Z1	Z2	L1	L2	L3	L4	L5	L6	L7	L8
107 031	15	1/2	45	150/200	26	13	45	38	26	70	100	150	200	62
111 151	15	1/2	65	150/200	26	13	65	38	26	70	100	150	200	82

DG = depth gauge

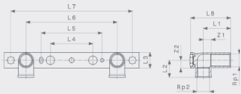

Gemini Mounting unit
Model 94478

article	Rp1	Rp2	L	DG	Z1	Z2	L1	L2	L3	L4	L5	L6	L7	L8
124 892	1/2	1/2	45	150/200	29	13	45	40	26	70	100	150	200	66

DG = depth gauge

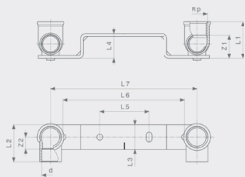

Gemini Mounting unit
Model 94476.0

article	d	Rp	DG	Z1	Z2	L1	L2	L3	L4	L5	L6	L7
123 628	12	1/2	150	17	13	32	34	25	25	50	125	150
101 091	15	1/2	150	20	12	34	36	25	25	50	125	150
108 021	18	1/2	150	22	12	37	38	25	25	50	125	150

DG = depth gauge

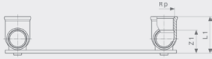

**Gemini Mounting unit
Model 94476.05**



article	d	Rp	DG	Z1	Z2	L1	L2	L3	L4	L5
121 167	12	1/2	150	17	13	32	34	25	50	150
104 986	15	1/2	150	20	12	34	36	25	50	150

DG = depth gauge

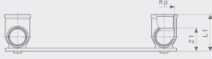

**Gemini Mounting unit
Model 94476.05NOR**



article	d	Rp	DG	Z1	Z2	L1	L2	L3	L4	L5
111 441	12	3/8	150	17	11	28	30	25	50	150
113 988	12	1/2	150							
113 179	15	1/2	150							

DG = depth gauge



**Gemini Mounting unit
Model 94476.09**



article	d	Rp	DG	Z1	Z2	L1	L2	L3	L4	L5	L6	L7
130 145	15	1/2	150	18	26	34	48	25	25	50	125	150

DG = depth gauge

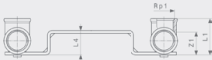

**Gemini Mounting unit
Model 94478.0**



article	Rp1	Rp2	DG	Z1	Z2	L1	L2	L3	L4	L5	L6	L7
118 754	1/2	1/2	150	28	15	44	38	25	25	50	125	150

DG = depth gauge



**Gemini Mounting unit
Model 94476EX**



article	d	Rp	DG	Z1	Z2	L1	L2	L3	L4	L5	L6
105 990	12	3/8	150	17	10	28	30	25	21	40	120

DG = depth gauge



**Gemini Mounting unit
Model 94476.1**

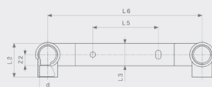

article	d	Rp	DG	Z1	Z2	L1	L2	L3	L4	L5	L6
106 119	15	1/2	200	20	12	34	36	25	25	100	200

DG = depth gauge

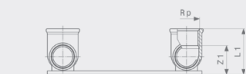

**Gemini Mounting unit
Model 94476.2**

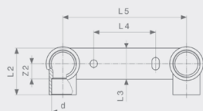

article	d	Rp	DG	Z1	Z2	L1	L2	L3	L4	L5
107 284	15	1/2	100	20	12	34	36	25	55	100

DG = depth gauge

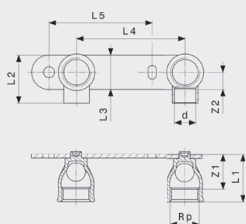

**Gemini Mounting unit
Model 94476.21**

article	d	Rp	DG	Z1	Z2	L1	L2	L3	L4	L5
268 138	15	1/2	80	20	12	34	36	25	80	75

DG = depth gauge

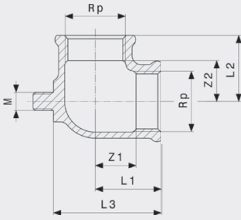

**Connection elbow 90°
Model 94477.0-713**

article	Rp	Z1	Z2	L1	L2	L3	M
374 570¹	½	10	10	25	25	40	8
489 298¹	¾	13	13	29	29	47	8
138 066²	1	15	15	34	34	57	8

M = thread type

¹) gunmetal

²) brass

WALL LEAD-INS

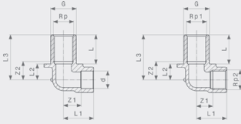

**Wall lead-in
- gunmetal
Model 3426**

article	Rp	d	Rp1	L	Rp2	G	Z1	Z2	L1	L2	L3
333 911¹			½	30	½	¾	16	19	31	16	46
333 928¹	½	15		30		¾	11	15	22	12	42
333 935	½	15		55		¾	11	40	22	12	68
448 936	½	18		30		¾	18	19	31	16	46

¹) for connection in pre-wall cistern

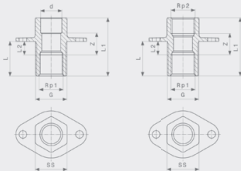

**Wall lead-in
- gunmetal
Model 3427**

article	d	Rp1	L	Rp2	G	Z	L1	L2	SS
333 942		½	30	½	¾	17	50	12	27
333 959	15		30		¾	20	48	12	19

SS = spanner size

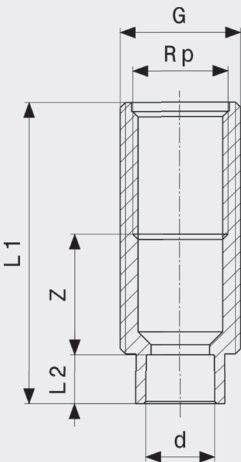

**Wall lead-in
- gunmetal
Model 3427.2**

article	d	L	Rp	G	Z	L1	L2
448 745	15	55	½	¾	25	66	11

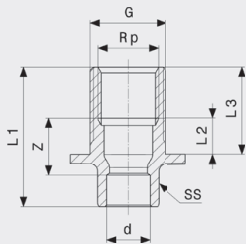

Wall lead-in
- gunmetal
Model 3427.1

article	d	L	Rp	G	Z	L1	L2	L3	SS
448 868	15	30	1/2	3/4	20	48	12	30	19

SS = spanner size



Hexagon nut
- brass
Model 1911

article	G	H	SS
103 347	3/4	6	33

SS = spanner size

order code	page	order code	page	order code	page	order code	page	order code	page
100 018	4	101 749	10	104 771	11	109 196	10	115 951	5
100 025	10	101 787	11	104 863	7	109 219	8	116 040	10
100 063	4	101 848	7	104 955	5	109 288	4	116 118	13
100 094	6	101 978	9	104 986	20	109 295	15	116 187	13
100 117	12	102 012	5	105 037	13	109 325	5	116 323	16
100 131	7	102 067	6	105 129	18	109 424	8	116 392	14
100 148	4	102 111	13	105 136	4	109 547	15	116 583	14
100 155	4	102 128	15	105 143	7	109 561	12	116 859	16
100 193	4	102 159	5	105 204	7	109 738	13	116 897	6
100 223	18	102 180	11	105 259	11	109 745	6	117 184	4
100 254	11	102 210	18	105 297	7	109 806	15	117 269	13
100 278	6	102 234	10	105 310	15	109 899	8	117 399	14
100 285	10	102 357	12	105 334	13	109 905	6	117 467	8
100 292	5	102 395	16	105 396	5	110 017	17	117 542	5
100 322	10	102 401	9	105 433	12	110 154	13	117 580	8
100 353	12	102 456	7	105 662	17	110 192	18	117 597	11
100 391	4	102 470	11	105 693	12	110 239	14	117 818	8
100 414	6	102 494	4	105 747	6	110 260	14	117 849	11
100 445	7	102 524	13	105 792	14	110 338	5	117 887	12
100 452	6	102 616	12	105 808	8	110 383	8	117 894	10
100 469	12	102 661	10	105 839	10	110 390	15	117 917	11
100 476	7	102 685	16	105 983	13	110 420	4	118 013	13
100 483	4	102 777	4	105 990	21	110 581	16	118 051	11
100 513	4	102 852	8	106 102	12	110 727	8	118 310	19
100 520	13	102 890	7	106 119	21	110 758	13	118 327	15
100 568	12	102 913	10	106 232	8	110 819	8	118 549	11
100 575	4	102 920	6	106 256	13	111 151	19	118 556	8
100 582	7	102 944	7	106 355	7	111 274	11	118 648	14
100 605	5	102 951	17	106 393	18	111 304	18	118 754	20
100 612	7	103 002	15	106 416	6	111 441	20	118 792	8
100 650	10	103 019	5	106 553	11	111 595	8	118 846	11
100 667	12	103 088	6	106 577	12	111 687	13	118 891	6
100 698	12	103 118	14	106 638	10	111 984	16	118 921	15
100 704	4	103 132	6	106 690	15	112 028	4	118 945	17
100 711	6	103 156	13	106 737	8	112 035	9	118 976	11
100 728	11	103 200	7	106 744	12	112 196	4	119 195	9
100 773	5	103 217	7	106 799	6	112 295	17	119 461	17
100 780	13	103 248	8	106 874	13	112 400	10	119 478	14
100 803	6	103 309	4	106 935	14	112 455	11	119 515	11
100 827	4	103 347	23	107 031	19	112 530	14	119 652	8
100 841	13	103 415	4	107 079	6	112 813	18	119 669	11
100 872	12	103 422	15	107 093	12	112 943	8	119 805	13
100 889	10	103 453	9	107 109	10	112 967	15	119 829	4
100 933	6	103 569	7	107 192	11	113 032	8	119 980	16
100 940	11	103 590	17	107 208	12	113 148	16	120 009	6
100 964	11	103 606	7	107 284	21	113 155	17	120 061	17
101 015	14	103 637	14	107 291	8	113 179	20	120 122	7
101 022	8	103 699	15	107 338	17	113 216	18	120 146	15
101 039	10	103 705	15	107 413	7	113 421	14	120 221	10
101 046	4	103 767	9	107 420	13	113 445	5	120 245	7
101 053	7	103 798	5	107 475	6	113 490	18	120 498	17
101 060	13	103 859	17	107 581	12	113 599	8	120 504	13
101 077	4	103 880	11	107 604	15	113 711	8	120 580	17
101 091	19	103 910	12	107 635	12	113 773	6	120 771	16
101 152	10	103 958	18	107 857	11	113 865	12	120 788	13
101 169	6	103 965	18	107 864	5	113 988	20	120 856	14
101 176	13	103 996	16	107 901	6	113 995	6	120 979	17
101 275	18	104 016	4	107 918	15	114 060	10	121 082	13
101 282	8	104 092	6	108 021	19	114 077	17	121 150	13
101 336	5	104 115	4	108 052	4	114 183	7	121 167	20
101 398	10	104 139	11	108 236	8	114 565	7	121 228	10
101 435	6	104 184	8	108 267	11	114 695	15	121 235	8
101 459	4	104 214	11	108 298	13	114 787	17	121 273	17
101 466	17	104 290	13	108 427	15	114 909	17	121 280	13
101 497	7	104 375	8	108 687	12	114 916	5	121 433	17
101 510	4	104 399	15	108 700	6	114 947	8	121 518	5
101 527	15	104 436	12	108 717	12	115 098	16	121 785	5
101 558	15	104 450	17	108 823	4	115 135	16	121 884	9
101 565	13	104 481	5	108 892	17	115 180	14	122 119	8
101 602	13	104 566	13	109 011	12	115 296	14	122 249	14
101 619	8	104 672	5	109 042	15	115 760	8	122 287	19
101 657	10	104 689	7	109 080	15	115 852	14	122 591	8
101 664	11	104 702	7	109 134	17	115 883	15	122 645	4
101 725	7	104 733	7	109 141	9	115 937	15	122 676	8

order code	page	order code	page	order code	page	order code	page	order code	page
122 683	15	144 098	17	467 463	4	594 374	13		
122 959	15	144 128	17	467 470	4	594 381	13		
123 390	9	144 203	12	467 487	5	594 398	13		
123 499	16	144 418	11	467 494	5	594 404	13		
123 628	19	144 425	4	467 500	4	594 411	6		
123 673	8	145 002	10	467 517	4	594 428	6		
123 796	13	146 368	16	467 524	6	594 435	6		
124 038	12	146 450	17	467 531	6	594 442	6		
124 076	13	146 481	12	467 548	6	595 227	8		
124 434	15	147 099	15	467 555	6	595 234	8		
124 540	13	148 256	15	467 562	7	595 241	8		
124 892	19	148 362	12	467 579	7	595 357	8		
125 080	4	149 970	12	467 586	7	595 364	8		
125 325	15	150 600	9	467 593	7	595 371	8		
125 479	8	150 709	14	467 609	7	633 837	5		
125 899	15	151 003	8	467 616	7	633 844	5		
125 998	16	151 614	10	467 623	7	634 254	4		
126 261	14	151 645	15	467 630	7	634 261	4		
126 940	10	151 676	12	467 647	7	634 278	13		
127 077	4	151 812	18	467 654	12	634 292	8		
127 732	14	152 734	9	467 661	12	634 308	14		
127 862	12	154 196	14	467 678	17				
128 029	5	157 678	9	467 685	17				
128 319	12	157 999	9	467 692	12				
128 968	6	158 071	4	467 708	12				
129 620	15	159 634	10	467 715	12				
130 114	12	160 586	11	467 722	12				
130 145	20	163 051	15	467 739	10				
130 367	16	163 419	11	467 746	10				
130 794	16	165 864	11	467 753	10				
131 029	9	165 918	16	467 760	10				
131 166	10	166 397	12	467 784	11				
131 722	8	167 202	16	467 791	18				
131 739	12	169 305	10	467 807	18				
131 838	11	173 494	12	475 758	11				
132 033	15	174 484	10	475 765	11				
132 620	10	176 174	14	475 772	9				
132 866	14	216 962	17	475 789	9				
132 873	11	220 839	15	489 298	22				
133 108	12	258 481	10	584 412	7				
133 252	11	258 955	9	584 429	7				
133 276	16	268 138	21	584 436	7				
133 313	14	288 341	16	584 443	7				
133 535	15	288 358	16	584 955	7				
134 464	9	288 365	16	584 962	7				
134 716	16	288 372	16	584 979	7				
134 815	16	288 389	16	584 986	7				
135 508	9	288 396	16	584 993	7				
135 911	8	288 402	16	585 006	7				
136 307	12	333 911	22	585 013	7				
136 635	6	333 928	22	585 020	7				
136 666	16	333 935	22	585 037	7				
136 673	10	333 942	22	585 044	7				
136 734	9	333 959	22	585 051	7				
137 021	8	374 570	22	585 068	7				
137 236	10	448 745	22	585 075	7				
138 066	22	448 868	23	585 082	7				
138 127	19	448 936	22	585 099	7				
138 202	10	464 301	13	585 112	13				
138 394	4	464 318	13	585 129	14				
138 431	4	464 325	13	585 136	13				
138 691	12	464 332	13	585 143	13				
138 745	16	464 349	13	592 585	7				
138 851	9	464 356	13	594 169	14				
140 007	10	464 363	13	594 176	14				
140 366	16	465 674	13	594 183	14				
140 823	9	465 681	13	594 190	14				
140 946	10	465 698	13	594 206	14				
141 905	10	465 704	13	594 213	14				
142 841	10	465 711	13	594 220	14				
142 872	13	465 728	13	594 237	14				
144 005	16	465 735	13	594 244	5				
144 043	4	465 742	4	594 350	4				
144 067	12	467 456	4	594 367	17				

model no.	page	model no.	page	model no.	page	model no.	page	model no.	page
1911	23								
3426	22								
3427	22								
3427.1	23								
3427.2	22								
94090G	12								
94092G	12								
94096	16								
94096G	17								
94098G	17								
94130G	9								
94180	9								
94243G	10								
94246G	11								
94270G	11								
94270GF	11								
94280G	10								
94330	14								
94330G	14								
94331G	15								
94340	15								
94340G	15								
94341G	15								
94343G	16								
94359	16								
94384G	16								
94471G	18								
94472G	18								
94472GL	18								
94476	19								
94476.0	19								
94476.05	20								
94476.05NOR	20								
94476.09	20								
94476.1	21								
94476.2	21								
94476.21	21								
94476EX	21								
94477.0-713	22								
94478	19								
94478.0	20								
94490G	19								
95001A	4								
95002A	4								
95040	5								
95041	4								
95060	5								
95085	5								
95086	5								
95090	6								
95092	6								
95130	6								
95130	7								
95130	8								
95240	13								
95243	13								
95243	14								
95270	12								
95290	17								
95301	17								